

NOTE: ALL MATERIAL COMPLIANT ROHS STANDARD

REVISION INFORMATION			
Rev.	Rev. Date	Modified By	Brief Description

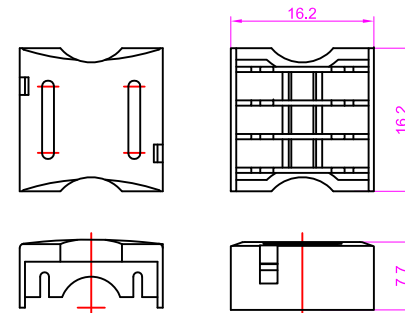

IDC Cap

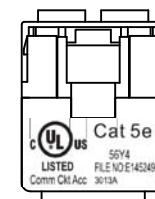
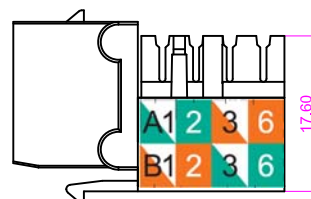
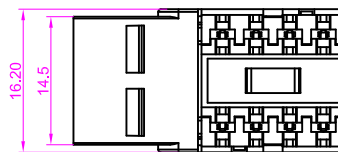
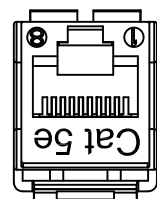
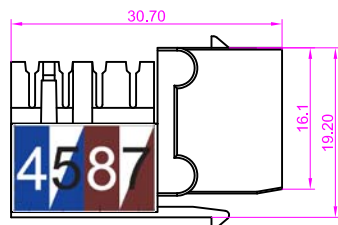
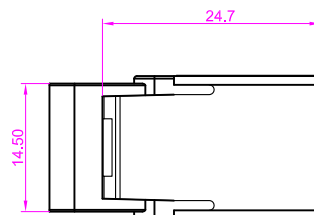

Part Number	COLOUR	QTY	G. W (LBS)	G. W (KGS)	
1	101602BL	PANTONE 3015C	1000	24.3	11
2	101602GN	PANTONE 7726C	1000	24.3	11
3	101602GY	PANTONE C001Gray4c	1000	24.3	11
4	101602IV	PANTONE 7501C	1000	24.3	11
5	101602OR	PANTONE 2023C	1000	24.3	11
6	101602RD	PANTONE 1925C	1000	24.3	11
7	101602WT	RAL 9016	1000	24.3	11
8	101602BK	PANTONE 433C	1000	24.3	11
9	101602YW	PANTONE 1225C	1000	24.3	11

## Physical Specification

Jack housing: ABS high-impact UL94V-0 thermoplastic  
 Spring wire: Phosphor Bronze C5210R-H, t=0.3mm Plating 120u" Matte Tin over 60u" Nickel undercoat, besides Plating 50u" Gold over the plated surface on contact area.

IDC housing: Polycarbonate resin high-impact UL94V-0 thermoplastic  
 IDC contact: Phosphor Bronze C5191R-H, t=0.4mm, 200u" Tin over 100u" Nickel undercoat

Insertion Life: 750 mating cycles with FCC compliant RJ-45 plug  
 Contact force: 100 grams with FCC compliant RJ-45 plug

Plug retention force: 11 lbf min  
 Durability: 200 termination cycles  
 Contact compatibility: Accommodates 22 to 26 AWG solid/24 AWG stranded  
 Operating Temperature Range: -10°C to 60°C  
 Storage Temperature Range: -40°C to 68°C  
 Humidity: 10%~90%RH

## Electrical

Insulation resistance: 500 M Ω  
 Dielectric withstanding voltage: 1000 V  
 DC current rating: 1.5 Amps  
 DC resistance: 0.1 Ω  
 Contact resistance: 20m Ω

ACCORDING TO ANSI/TIA-568-C.2  
 REQUIREMENTS  
 C5e CHANNEL COMPLIANT

Cat 5e

56Y4  
 E145249

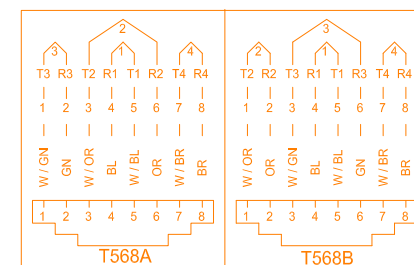

NO.	PART NAME	SPECIFICATION DESCRIPTION	QTY	UNIT
③				
②				
①				



DRAWN BY	WLL	DATE:	2017/08/11	DESCRIPTION:	Cat.5E RJ45 110 Type Keystone Jack
CHECKED BY		SHEET	1 of 1	ITEM NO.	101602XX
APPROVED BY		SCALE	1:2	REV.	01
		UNIT:	mm		