

NOTE: ALL MATERIAL COMPLIANT ROHS STANDARD

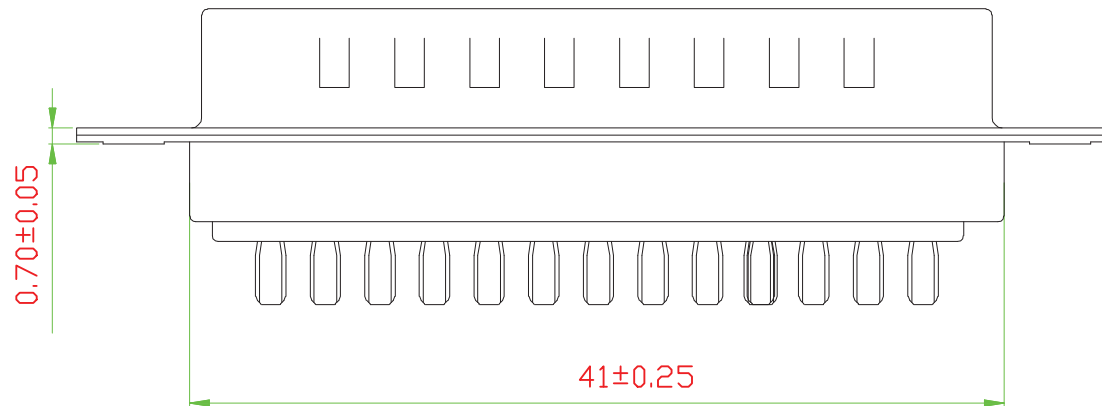

REVISION INFORMATION			
Rev.	Rev. Date	Modified By	Brief Description
001	2022. 4. 16	LWZ	ADD Point marked

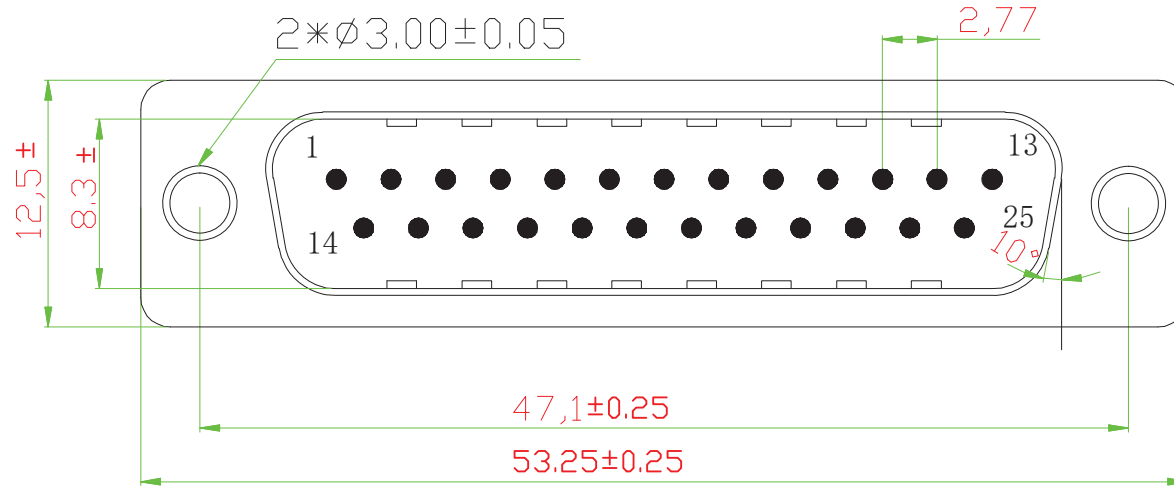
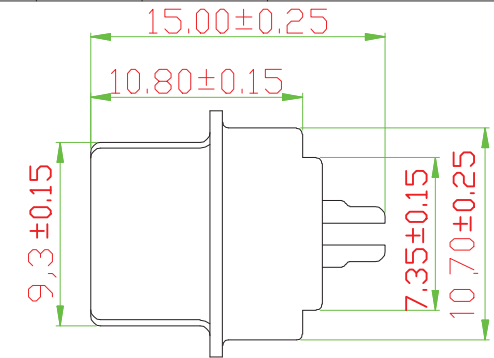

**Remark:**

1. Contacts: gold flash plated bronze contacts segment remaining pure tin plating
2. Nickel-plated steel shell before the shell after shell steel tin
3. Appearance requirements:  
No loose plastic parts. Breakage  
Metal parts without deformation. No damage, coating well.  
No black. Corrosion phenomenon  
Terminal no offset. Pins height the same, no skew phenomenon.
4. Salt Requirements:  
Copper plated:8HourNSS  
Copper (steel) Nickel:8HourNSS
5. Products using plastic boxes packed per box 50PCS, can not appear pin,  
Housing without damage; mixing; sprawl. Packing Packed in a dry, moisture.  
Dust and mildew in the box. Storage period not exceeding two years from the date of manufacture.

NO.	PART NAME	SPECIFICATION DESCRIPTION	QTY	UNIT
③				
②				
①				



DRAWN BY	DATE: 2022. 4. 16	DESCRIPTION: DB25 Male Solder Cup Connector
CHECKED BY	SHEET 1 of 1	ITEM NO. 273005
APPROVED BY	SCALE 1:1	REV. 00 UNIT: mm