

NOTE:ALL MATERIAL COMPLIANT ROHS STANDARD

REVISION INFORMATION

Rev.	Rev. Date	Modified By	Brief Description

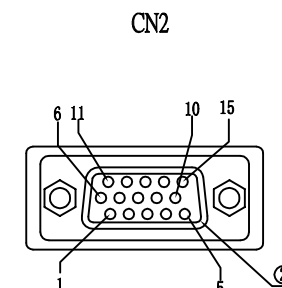
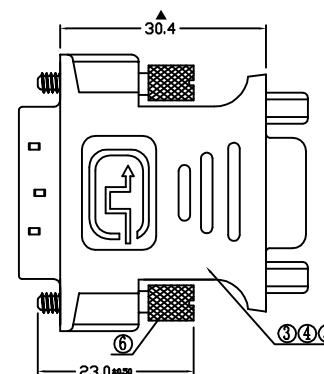
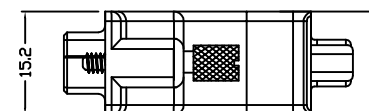
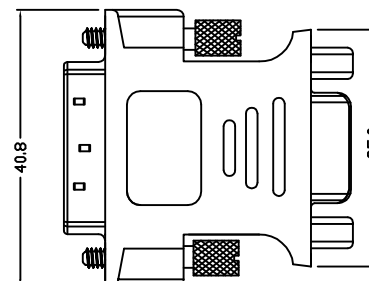
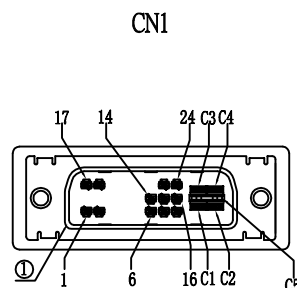

WIRE DIAGRAM

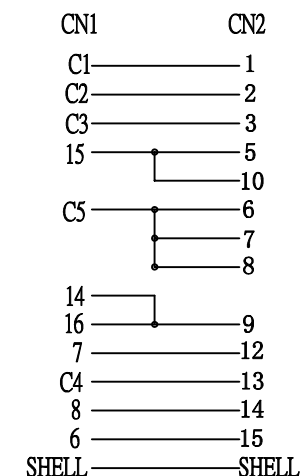

NOTE:

- 100% short/open circuited&wrong connection test conditions.
- Conduction impedance $\leq 5\Omega$, Insulation resistance $\geq 10M\Omega$. High voltage test, DC300V/10mS
- Products using PCB board connection
- Marked with ▲ which is important measurement dimensions

①	CONN	DVI M (12+5) CONNECOR GOLD PLATED	1	PCS
②	CONN	VGA 15P F CONNECOR GOLD PLATED	1	PCS
③	THE CONNECTION	PCB CONNECTION T=1.6MM	1	PCS
④	PVC	MOLDED 45P PVC BLACK	5.1	G
⑤	PVC	MOLDED 45P PVC BLACK	11.7	G
⑥	SCREWS	NICKEL PLATED	2	PCS
NO.	PART NAME	SPECIFICATION DESCRIPTION	QTY	UNIT

Unless specified on the drawing,
tolerances are per the follows:

.	+1
.X	+0.2
.XX	+0.05



DRAWN BY

DATE:
2016/06/23

DESCRIPTION:
DVI-A Male (12+5) VGA (DB15HD)
Female Adapter Gold plated

CHECKED BY

SHEET 1of1

ITEM NO. 180643

APPROVED BY

SCALE 1:1

REV. 00

UNIT:mm

